

## Light-emitting diode module

### Prism PRO1 HE+ 24V

#### TECHNICAL INFORMATION

LED type	2835
Input	24V DC
Color temperature	6500 K / 8500 K
Beam angle	165°
Protection level	IP 67
Center-to-center distance	140 mm
Working temperature	-30°C + 50°C
Available colors	
Power	<b>0,36 W</b>
Light output	<b>63 lm</b>

**FOR CHANNEL LETTERS**

MODULE DESIGNED CHANNEL LETTERS

**DEPTH 60-100 MM**

BEST FOR 60-100MM DEEP LIGHTBOXES

**1:1.8 RATIO**

RECOMMENDED DEPTH: C-C DISTANCE RATIO

**UPTO 175LM/W**

HIGH EFFICIENCY LED INSIDE

**IP 67**

DUST AND WATER PROTECTED

**63 lm**

HIGH BRIGHTNESS 63 LM PER MODULE

**6500 K**

6500 K AND OTHER COLORS

**7 YEARS WARRANTY**

7 YEAR EXTENDED WARRANTY

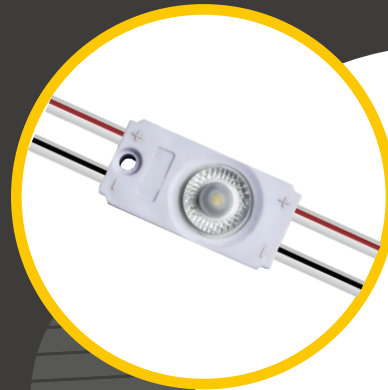

#### LIGHT DISTRIBUTION GRAPH

Beam angle is 165°

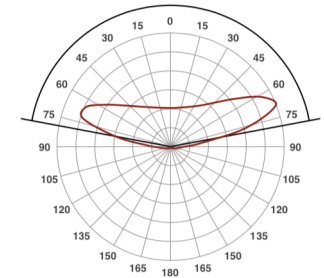

#### DIMENSIONS

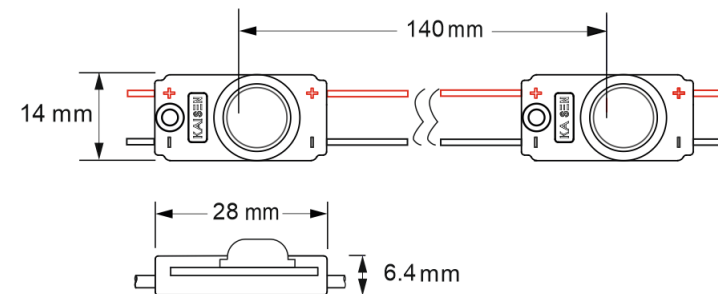

#### CONNECTION

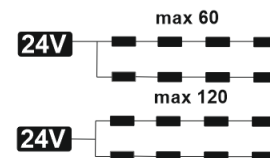

#### PACKAGING

Packing type	Chain	Package	Box
Quantity	20 pcs	200 pcs	3200 pcs
Weight	0,13 kg	1,34kg	21,5 kg

